

PLATE Ref. No.	PART No.	QUANTITY					STEERING		DESCRIPTION	CHANGE POINT	BULLETIN REFERENCE
		ALL	ST.	Sl. Mk 1	S2.	S2. Fed.	RH	LH			
	046 B 0001		1						Body Shell	Up to 0541	
	046 B 0001A			1					Body Shell	From 0542 to 0644	
BA.1.	054 B 0001				1				Body Shell		
	054 B 1800				1		+		Body Shell (pre-24 in. headlamp centres)	Up to 2950	
	A054 B 1800				1		+		Body Shell (24 in. headlamp centres)	From 0001P	
	054 B 1801				1			+	Body Shell (pre-24 in. headlamp centres)	From 0645 to 2944	
	C054 B 1801				1			+	Body Shell (24 in. headlamp centres)	From 0001Q	
	A054 B 1801					1		+	Body Shell (pre-24 in. headlamp centres)	From 1066 to 2061	
	D054 B 1801					1		+	Body Shell (24 in. headlamp centres)	From 2067 to 2951	
	B054 B 1801					1		+	Body Shell (24 in. headlamp centres - '65')	From Chassis No. 7001.03.0001R	
BA.2.	046 B 0088		1	1					Door Shell LH		
	054 B 0089				1				Door Shell LH	Up to Chassis No. 1065	
	A054 B 0089				1	1			Door Shell LH	From Chassis No. 1066	
BA.3.	046 B 0089		1	1					Door Shell RH		
	054 B 0088				1				Door Shell RH	Up to Chassis No. 1065	
	A054 B 0088				1	1			Door Shell RH	From Chassis No 1066	
BA.4.	046 B 0030		1						Bonnet Lid		
	A046 B 0030			1	1	1			Bonnet Lid		
	054 B 1820				1	1			Reinforcing Strip	From Chassis No. 2640	) Service III 1969/40 )
	036 B 6033				6	6			Rivet Reinforcing Strip Mounting	From Chassis No. 2640	
BA.5.	046 B 0040		1						Rear Compartment Lid		
	A046 B 0040			1	1	1			Rear Compartment Lid		
	054 B 0562				1	1			Sealing - Front Stowage Compartment		

PLATE Ref: No.	PART No.	QUANTITY					STEERING		DESCRIPTION	CHANGE POINT	BULLETIN REFERENCE
		ALL	ST.	ST. Mk 1	S2.	S2. Fed.	RH	LH			
BA.6.	054 B 1387				1				Blanking Panel		
	A054 B 1387					1			Blanking Panel		
BA.7.	054 B 1386				1	1			Blanking Panel		
	PSTS 1008				10	10			Screw )		
	036 B 6003				10	10			Nut )	Blanking Panels to Body	
	046 B 0059		1	1					Luggage Box		
BA.8.	054 B 0059				1	1			Luggage Box		
	451A	2							Nut )		
	PUPS 1016	2							Screw )	Luggage Box to Chassis	
	A03W 1606	2							Washer )		
	W0060	2							Spacer )		
BA.9.	046 B 2007	1							Heat Shield		
	046 B 2005	1							Heat Shield		
	435	4							Rivet )		
	AUPN 030F	4							Nut )	Heat Shield to Luggage Box	
	A03W 0806	4							Washer )		
	046 B 0241	1	1						Cover - Battery		
	MUPS 1016	2	2						Screw - Battery Cover		
	046 B 0029	-	-						Replaced by 046B0029A		
BA.10.	046 B 0029A	1							Windscreen		
	054 B 0029	1							Windscreen - Shaded, Optional		
BA.11.	046 B 0549	1	1	1					Weatherstrip - Windscreen	Upto Chassis No.	
	046 R 0549					1			Weatherstrip - Windscreen	Upto Chassis No. 2951	
	A050 B 6182					1			Mastic Sealer	From Chassis No. 7001.03.0001R	
05.70											

PLATE Ref: No.	PART No.	QUANTITY					STEERING		DESCRIPTION	CHANGE POINT	BULLETIN REFERENCE
		ALL	ST.	ST. Mk 1	S2.	S2. Fed.	RH	LH			
	A050 B 6181					1			Mastic Sealer	From Chassis No. 7001.03.0001R	
	A054 B 6124					2			Mounting Blocks	From Chassis No. 7001.03.0001R	
BA.12.	046 B 6002		1	1	1				Filler Strip (450")		
	046 B 6002					1			Filler Strip	Upto Chassis No. 2951	
	A054 B 6118					1			Finisher, Top	From Chassis No. 7701.03.0001R	
	A054 B 6119					1			Finisher, Bottom	From Chassis No. 7701.03.0001R	
	A054 B 6120					1			Finisher, LH	From Chassis No. 7701.03.0001R	
	A054 B 6126					1			Finisher, RH	From Chassis No. 7701.03.0001R	
	A054 B 6125					2			Corner Clip, Top	From Chassis No. 7701.03.0001R	
	A050 B 6183					2			Corner Clip, Bottom	From Chassis No. 7701.03.0001R	
	A054 B 6121					1			Filler - Top Internal	From Chassis No. 7701.03.0001R	
	A054 B 6122					1			Filler - Bottom Internal	From Chassis No. 7701.03.0001R	

PLATE Ref: No.	PART No.	QUANTITY					STEERING		DESCRIPTION	CHANGE POINT	BULLETIN REFERENCE
		ALL	ST.	ST. Mk 1	S2.	S2. Fed.	RH	LH			
	A054 B 6123					2			Filler - Side Internal	From Chassis No. 7701.03.0001R	
BA. 13.	046 B 0349	1							Rear Screen		
	B046 B 0349	1							Rear Screen Shaded Optional		
	046 B 6004	-							Replaced by 054 B 1769		
BA. 14.	054 B 1769	1							Weatherstrip - Rear Screen		
BA. 15.	046 B 6003	1							Filler Strip - Rear Screen		
	046 B 6039	-							Replaced by 036 B 6031		
BA. 16.	036 B 6031	1							Internal Rear View Mirror		
	046 B 6108		1	1					Sunvisor		
BA. 17.	054 B 1720				2	2			Sunvisor		

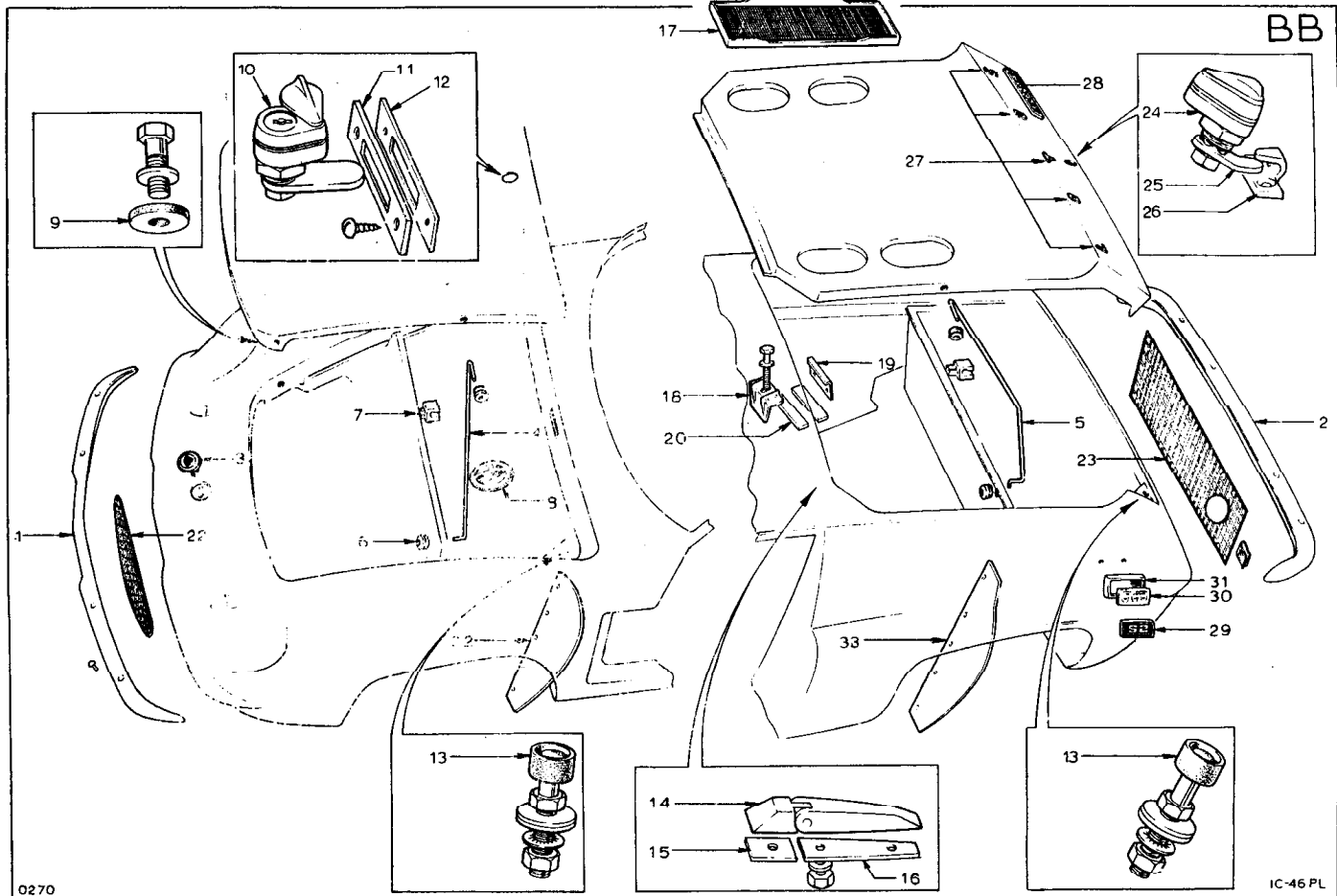

PLATE Ref: No.	PART No.	QUANTITY					STEERING		DESCRIPTION	CHANGE POINT	BULLETIN REFERENCE
		ALL	SI.	SI. Mk 1	S2.	S2. Fed.	RH	LH			
BB.1.	046 B 6011	1							Bumper - front		
BB.2.	046 B 6012	1							Bumper - rear		
	046 B 6013	2							Blanking Rivet		
	A050 B 6033	8							Bolt )		
	116 AA	8							Washer, Fibre )		
	A05W 1007	8							Washer )	Bumper Mounting	
	S05W 0000	8							Washer, Spring )		
	214A	8							Nut )		
BB.3.	026 B 0269	1							Badge - Yellow and Green		
	2RAN 000H	2							Nut )	Badge Mounting	
	A03W 0806	2							Washer )		
	046 B 1131		1	1					Stay - Front Lid Support		
BB.4.	054 B 1535				1	1			Stay - Front Lid Support		
BB.5.	046 B 1131	1							Stay - Rear Lid Support		
	046 B.6048	4							Grommet - Stay Pivot		
BB.6.	036 B 6010	4							Grommet - Stay Pivot		
	046 B 6023		2	2					Clip - Stay Storage		
BB.7.	054 B 1693	2							Clip - Stay Storage		
	046 B 1289		1	1					Strip-Lid Periphery Sealing		
	A036 B 6213	1							Strip-Lid Periphery Sealing		
BB.8.	026 B 0371				1	1			Grommet - Handbrake Fixing Access		
	054 J 6005					1			Grommet - Front Wishbone Access	Up to	
	036 H 6289				1	1			Grommet - Front Wishbone Access	From	
BB.9.	054 B 6107	2							Rubber Washer )		
	XUPB 0528	2							Bolt )	Bonnet Fixing	
	A05W 1007	2							Washer )		
12.70.											

PLATE Ref: No.	PART No.	QUANTITY					STEERING		DESCRIPTION	CHANGE POINT	BULLETIN REFERENCE
		ALL	S1.	S1. Mk 1	S2.	S2. Fed.	RH	LH			
	046 B 6043		2								'Oddie' Fastener
	046 B 6044		2								Mounting Plate - 'Oddie' Fastener
	046 B 6045		2								Clip - 'Oddie' Fastener
	036 B 6033		6								Rivet - Mounting Plate to Bonnet
BB.10.	046 B 6112			1	1	1					Lock - Bonnet
	046 B 1362			1	1	1					Tab - Bonnet Lock
BB.11.	046 B 1368			1	1	1					Plate - Bonnet Lock
BB.12.	046 B 1369			1	1	1					Tapping Plate
	KSES 1016			2	2	2					Screw - Tapping Plate
BB.13.	036 B 6030			4	4	4					Buffer - Bonnet and Rear Lid
	XUPB 0520			2	2	2					Bolt - Bonnet Buffer
	XUPB 0524			2	2	2					Bolt - Rear Lid Buffer
	A05W 1606			8	8	8					Washer )
	LO5W 0000			4	4	4					Washer ) Buffer Mounting
	AUPN 050H			8	8	8					Nut )
BB.14.	036 B 6006	2									Hinge - Rear Lid
BB.15.	A036 B 1111	2									Gasket - Rear Lid Hinge
BB.16.	A036 B 1112	2									Gasket - Rear Lid Hings
	AUPN 040P	4									Nut )
	A04W 1606	4									Washer ) Hinge to Lid
	XUPN 050P	2									Nut )
	A05W 1606	2									Washer ) Hinge to Body
BB.17.	046 B 1119	2									Grille - Vent Rear Lid
	PS23 0612	8									Screw )
	036 B 6001	8									Nut ) Vent Grille to Lid
12.70											



PLATE Ref: No.	PART No.	QUANTITY					STEERING		DESCRIPTION	CHANGE POINT	BULLETIN REFERENCE
		ALL	SI.	SI. Mk 1	S2.	S2. Fed.	RH	LH			
	054 B 6020				1	1			Battery Clamp		
BB.18.	036 M 6005				1	1			Battery Clamp		
	XUPB 0532				1	1			Bolt ) Battery Clamping		
	115				1	1			Washer )		
BB.19.	050 B 1207				1	1			Angle - Battery Mounting		
	036 B 6053				2	2			Rivet - Battery Mounting Angle to Body		
BB.20.	054 B 6021				2	2			Pad - Battery Seating		
BB.22.	046 B 0272	1							Grille - Front		
	046 B 1073		1						Grille - Rear		
	046 B 1073			1					Grille - Rear		
	A046 B 1073			1					Grille - Rear		
BB.23.	054 B 1073				1	1			Grille - Rear		
	RSTS 0808	8							Screw )		
	036 B 6002	8							Nut ) Grille to Body		
	A03W 0806	8							Washer )		
	046 B 6046		2						'Oddie' Fastener		
	046 B 6044		2						Mounting Plate - 'Oddie' Fastener		
	046 B 6045		2						Clip ) 'Oddie' Fastener		
	046 B 6047		2						Washer )		
	036 B 6033		6						Rivet - Mounting Plate to Rear Lid		
BB.24.	046 B 6112		1	1	1				Lock - Rear Lid		
BB.25.	046 B 1367		1	1	1				Tab - Rear Lid Locking		
BB.26.	046 B 1366		1	1	1				Latch Plate - Rear Lid Locking		
	PSTS 0808		2	2	2				Screw )		
	A032 0806		2	2	2				Washer ) Latch Plate to Body		
	423		2	2	2				Nut )		
12.70											

Up to Chassis No. 0541  
From Chassis No. 0542

PLATE Ref: No.	PART No.	QUANTITY					STEERING		DESCRIPTION	CHANGE POINT	BULLETIN REFERENCE
		ALL	ST.	ST. Mk I	S2.	S2. Fed.	RH	LH			
BB.27	036 B 0544				1	1			Nameplate 'L'		
	036 B 0545				1	1			Nameplate 'O'		
	036 B 0546				1	1			Nameplate 'T'		
	036 B 0547				1	1			Nameplate 'U'		
	036 B 0546				1	1			Nameplate 'S'		
	036 B 6024				17	17			Fixing Clip - Nameplate		
BB.28.	054 B 1512				1	1			Europe Badge - English Speaking		
	046 B 1201			1	1				Europe Badge - Continental		
	036 B 0501A	1	1						Badge 'Indianapolis'		
	036 B 0501B	1	1						Badge 'World Champions'		
	036 B 0502	2	2						Packing - Badge		
	046 B 6027	2	2						Bezel		
	046 B 6028	6	6						Clip		
BB.29.	054 B 1425				1	1			Badge - 'S.2.'		
BB.30.	A036 B 2073				1	1			Badge - 'World Champions' (1963, 1965, 1968, 1970)		
BB.31.	A036 B 6341				1	1			Bezel		
	443				3	3			Clip, Bezel		
BB.32.	054 B 1271				2	2			Dust Shield, Front		
BB.33.	054 B 1271				2	2			Dust Shield, Rear		
	036 B 6033				24	24			Rivet )		
	A024 0603				48	48			Washer ) Dust Shield Mounting		
	054 B 0599				1	1			Stud )		
	036 D 6000				1	1			Nut ) Spare Wheel Clamping		Service III 1970/3
	A054 B 1908			AR	AR				Washer		
	026 B 0372					2			Grommet		

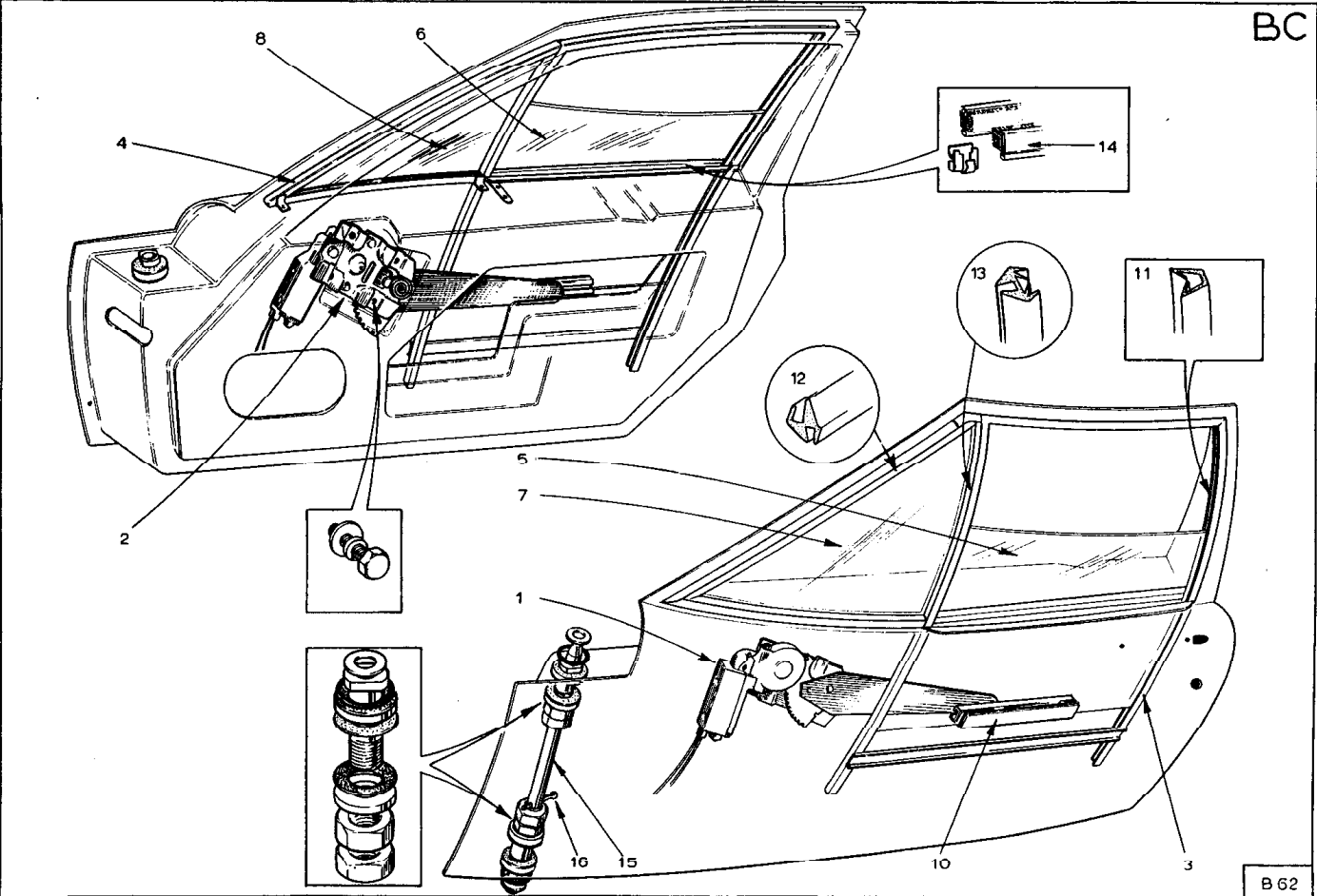

PLATE Ref. No.	PART No.	QUANTITY					STEERING		DESCRIPTION	CHANGE POINT	BULLETIN REFERENCE
		ALL	SI.	SI. Mk 1	S2.	S2. Fed.	RH	LH			
BC.1.	054 B 1495				1	1			Window Lift Motor LH	From Chassis No. 0645	
	054 B 1496				1	1			Window Lift Motor RH	From Chassis No. 0645	
	XUFB 0418				8	8			Bolt )		
	A04W 1606				8	8			Washer )	Window Lift Motor to Door	From Chassis No. 0645
	L04W 0000				8	8			Washer )		
	046 B 6105		2	2					Side Window Surround	Upto Chassis No. 0644	
	046 B 0659			1					Dividing Channel Side Window LH	From Chassis No. 0300, including 0270, 0271 & 0272, to 0644	
	046 B 0660			1					Dividing Channel Side Window RH	From Chassis No. 0300, including 0270, 0271 & 0272, to 0644	
	MUPS 0408			4					Screw )		
	YUFW 040H			4					Nut )	Dividing Channel Mounting	From Chassis No. 0300, including 0271, 0272 & 0273, to 0644
A02W 0603			4					Washer )			
BC.3.	054 B 0791				1	1			Window Frame LH	From Chassis No. 0645	
	054 B 0792				1	1			Window Frame RH	From Chassis No. 0645	
BC.4.	054 B 0709				1	1			Quarter Light Frame LH	From Chassis No. 0645	
	054 B 0790				1	1			Quarter Light Frame RH	From Chassis No. 0645	
	036 B 6033				14	14			Rivet )		
	PUCS 0408				4	4			Screw )		
	A02W 0603				4	4			Washer )	Window Frames to Door	From Chassis No. 0645
	YUNC 040F				4	4			Nut )		
	046 B 0667		1						Side Window LH	Upto Chassis No. 0299 excluding 0270, 0271 and 0272	
	A046 B 0667			1					Side Window LH	From Chassis No. 0300, including 0270, 0271 & 0272, to 0644	

PLATE Ref: No.	PART No.	QUANTITY					STEERING		DESCRIPTION	CHANGE POINT	BULLETIN REFERENCE
		ALL	ST.	ST. Mk 1	S2.	S2. Fed.	RH	LH			
BC.5.	054 B 0667				1	1			Side Window LH	From Chassis No. 0645 to	
	054 B 0667A								Side Window LH Shaded Optional		
	046 B 0668		1						Side Window RH	Upto Chassis No. 0299 excluding 0270, 0271 & 0272	
	A046 B 0668			1					Side Window RH	From Chassis No. 0300, including 0270, 0271, & 0272, to 0644	
BC.6.	054 B 0668				1	1			Side Window RH	From Chassis No. 0645 to	
	054 B 0668A								Side Window RH Shaded Optional		
	046 B 0669			1					Quarter Light Glass	From Chassis No. 0300, including 0270, 0271 & 0272, to 0644	
	054 B 0669				1	1			Quarter Light Glass replaced by 054 B 0669A	From Chassis No. 0645 to 1479	
BC.7.	054 B 0669A				1	1			Quarter Light Glass LH	From Chassis No. 1480 to	
	B054 B 0669								Quarter Light Glass LH Shaded Optional		
	046 B 0670			1					Quarter Light Glass	From Chassis No. 0300, including 0270, 0271 & 0272, to 0644	
	054 B 0670				1	1			Quarter Light Glass replaced by 054 B 0670A	From Chassis No. 0645 to 1479	
BC.8.	054 B 0670A				1	1			Quarter Light Glass RH	From Chassis No. 1480 to	
	B054 B 0670								Quarter Light Glass RH Shaded Optional		
05.70											

PLATE Ref: No.	PART No.	QUANTITY					STEERING		DESCRIPTION	CHANGE POINT	BULLETIN REFERENCE
		ALL	ST.	ST. Mk 1	S2.	S2. Fed.	RH	LH			
BC.10.	054 B 0091				2	2			Channel - Window Lift		
	054 B 6108				2	2			'Everseal' Strip - Window Lift Channel		
	046 B 6117			1					Side Window Channel LH		From Chassis No. 0300 including 0270, 0271 & 0272, to 1065.
	046 B 6118			1					Side window Channel RH		From Chassis No. 0300, including 0270, 0271, & 0272, to 1065.
BC.11.	054 B 6023				1	1			Side window Channel		From Chassis No. 1066
BC.12.	A054 B 1899				1	1			Seal Channel - Quarter Light, Front & Base		From Chassis No 1066
	046 B 6119			2					Seal Channel - Quarter Light		From Chassis No. 0300, including 0270, 0271 & 0272, to 1065.
BC.13.	A054 B 1898				1	1			Seal Channel - Quarter Light to Dividing Channel		From Chassis No. 1066
BC.14.	050 B 6011				4	4			Weather Strip - Side Window		From Chassis No. 1066
	054 B 6106				16	16			Clip - Weatherstrip to Frame		From Chassis No. 1066
BC.15.	046 B 0073	2							Pivot Pin - Door Hinge		
	A054 B 2000	4							Bush )		
	046 B 6024	4							*O* Ring )		
	AUPN 120H	8							Nut )		
	128 D	8							Washer ) Door Hinge		
	128 CA	AR							Washer )		
	W015	12							Abrasive Washer )		
									Split Pin )		
BC.16.	054 B 6103	2							Catch - Side Window		
	046 B 1979 46-01370			4							From Chassis No. 0300 including 0270, 0271 and 0272

PLATE Ref: No.	PART No.	QUANTITY					STEERING		DESCRIPTION	CHANGE POINT	BULLETIN REFERENCE
		ALL	ST.	S1. Mk 1	S2.	S2. Fed.	RH	LH			
	W0135			4							
	046 B 6114			4							
	A03W 0605			4					Catch to Side Window	From Chassis No. 0300 including 0270, 0271 and 0272	
	046 B 6115			8					Washer, Fibre )		
	036 B 6007			4					Snapsac - Catch	From Chassis No. 0300 including 0270, 0271 and 0272	
	046 B 1361			4					Carrier Bracket - Side Window	From Chassis No. 0300 including 0270, 0271 and 0272	
	050 B 6003			4					Rivet )	From Chassis No. 0300 including 0270, 0271 and 0272	
	A03W 0605			4					Washer ) Carrier Bracket to Body		

BD

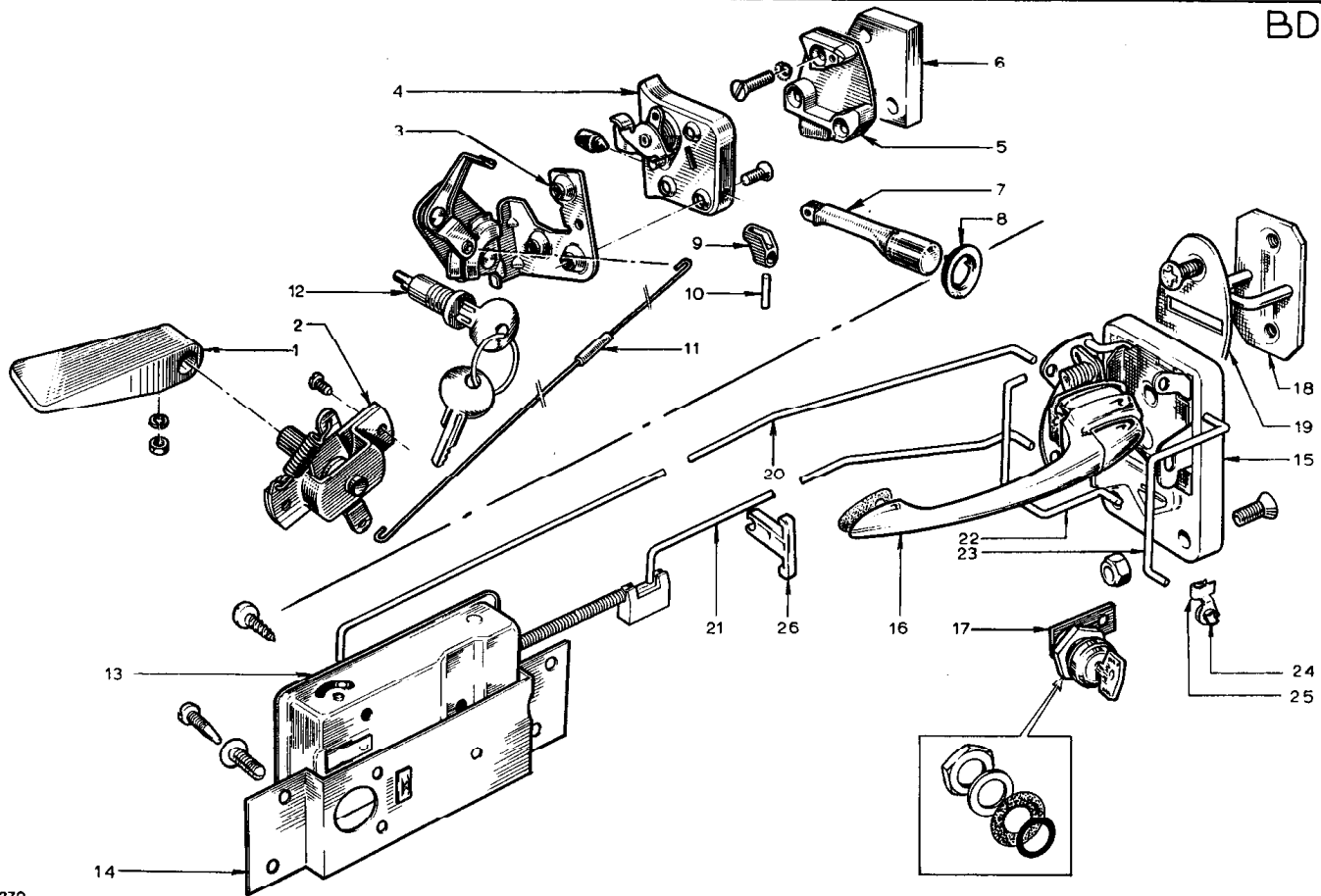

0270

IC-46PL



PLATE Ref: No.	PART No.	QUANTITY					STEERING		DESCRIPTION	CHANGE POINT	BULLETIN REFERENCE
		ALL	ST.	ST. Mk 1	S2.	S2. Fed.	RH	LH			
BD.1.	046 B 6065		1	1					Upto Chassis No. 1065		
	046 B 6065				1			Handle - Interior Door LH			
	046 B 6066		1	1				Handle - Interior Door LH			
	046 B 6066				1			Handle - Interior Door RH			
BD.2.	046 B 6067		1	1				Handle - Interior Door RH	Upto Chassis No. 1065		
	046 B 6067				1			Remote Control LH			
	046 B 6068		1	1				Remote Control LH			
	046 B 6068				1			Remote Control RH			
BD.3.	046 B 6055		1	1				Remote Control RH	Upto Chassis No. 1065		
	046 B 6055				1			Door Lock LH			
	046 B 6056			1				Door Lock LH			
	046 B 6056				1			Door Lock RH			
BD.4.	046 B 6053		1	1				Door Lock RH	Upto Chassis No. 1065		
	046 B 6053				1			Door Lock Striker LH			
	046 B 6054		1	1				Door Lock Striker LH			
	046 B 6054				1			Door Lock Striker RH			
BD.5.	046 B 6051		1	1				Door Lock Striker RH	Upto Chassis No. 1065		
	046 B 6051				1			Catch Plate LH			
	046 B 6052		1	1				Catch Plate LH			
	046 B 6052				1			Catch Plate RH			
BD.6.	046 B 1095		2	2				Catch Plate RH	Upto Chassis No. 1065		
	046 B 1095				2			Tapping Plate			
BD.7.	046 B 6058		1	1				Tapping Plate	Upto Chassis No. 1065		
	046 B 6058				1			Push Button LH			
	046 B 6059		1	1				Push Button LH			
	046 B 6059				1			Push Button RH			
BD.8.	046 B 6060		2	2				Push Button RH	Upto Chassis No. 1065		
	046 B 6060				2			Escutcheon			
03.70								Escutcheon	Upto Chassis No. 1065		

PLATE Ref: No.	PART No.	QUANTITY				STEERING		DESCRIPTION	CHANGE POINT	BULLETIN REFERENCE
		ALL	ST.	ST. Mk 1	S2.	S2. Fed.	RH			
BD.9.	046 B 6061	2	2					Lock Tab		
	046 B 6061			2				Lock Tab	Up to Chassis No.1065	
BD.10.	046 B 6062	2	2					Tension Pin		
	046 B 6062			2				Tension Pin	Up to Chassis No.1065	
BD.11.	046 B 1129	2	2					Remote Control Rod		
	046 B 1129			2				Remote Control Rod	Up to Chassis No.1065	
BD.12.	046 B 6064	2	2					Lock Barrel		
	046 B 6064			2				Lock Barrel	Up to Chassis No.1065	
BD.13.	036 B 6050			1	1			Remote Control LH	From Chassis No.1066	
	036 B 6051			1	1			Remote Control RH	From Chassis No.1066	
BD.14.	054 B 1629			1	1			Mounting Bracket - Remote Control LH	From Chassis No.1066	
	054 B 1630			1	1			Mounting Bracket - Remote Control RH	From Chassis No.1066	
	036 B 6123			4	4			Tappit - Mounting Bracket to Door Shell	From chassis No.1066	
	RSTS 1008			6	6			Screw )	From Chassis No.1066	
	046 B 6126			6	6			Nut ) Remote Control to Mounting Bracket	From Chassis No.1066	
BD.15.	036 B 6048			1	1			Door Lock LH	From Chassis No.1066	
	036 B 6049			1	1			Door Lock RH	From Chassis No.1066	
	KUPS 0416			8	8			Screw ) Door Lock to Door	From Chassis No.1066	
	YUPW 040F			8	8			Nut )	From Chassis No.1066	
BD.16.	036 B 6052			1	1			Door Handle - Exterior LH	From Chassis No.1066	
	036 B 6149			2	2			Gasket, Small ) Door Handle to Door	From Chassis No.1066	
	036 B 6095			2	2			Gasket, Large )	From Chassis No.1066	
	XUPS 1010			2	2			Screw ) Door Handle to Door	From Chassis No.1066	
	A03W 0605			2	2			Washer )	From Chassis No.1066	
BD.17.	A036 B 6191			2	2			Private Door Lock LH and RH	From Chassis No.1066	

PLATE Ref: No.	PART No.	QUANTITY					STEERING		DESCRIPTION	CHANGE POINT	BULLETIN REFERENCE
		ALL	SI.	SI. Mk 1	S2.	S2. Fed.	RH	LH			
	IJFN 120P				2	2			Nut )		From Chassis No.1066
	036 B 1440				2	2			Washer ) Private Lock Mounting		From Chassis No.1066
	A036 B 1884				2	2			Friction Washer		From Chassis No.1066
	036 B 6096				2	2			Gasket		From Chassis No.1066
BD.18.	036 B 6054				2	2			Striker Plate		From Chassis No.1066
BD.19.	036 B 6055				2	2			Cover Plate		From Chassis No.1066
	KUPS 0416				4	4			Screw - Striker Mounting		From Chassis No. 1066
BD.20.	054 B 1411				1	1			Locking Rod - Remote Control to Lock LH		From Chassis No.1066
	054 B 1412				1	1			Locking Rod - Remote Control to Lock RH		From Chassis No.1066
BD.21.	054 B 1413				1	1			Wire - Remote Control to Lock LH		From Chassis No.1066
	054 B 1414				1	1			Wire - Remote Control to Lock RH		From Chassis No.1066
BD.22.	054 B 1415				1	1			Wire - Handle to Lock LH		From Chassis No.1066
	054 B 1416				1	1			Wire - Handle to Lock RH		From Chassis No.1066
BD.23.	054 B 1423				1	1			Wire - Private Lock to Lock LH		From Chassis No.1066
	054 B 1424				1	1			Wire - Private Lock to Lock RH		From Chassis No.1066
BD.24	036 B 6056				12	12			Bush - Remote Control wire Fixing		From Chassis No.1066
BD.25.	036 B 6098				12	12			Fastener - Remote Control Wire Fixing		From Chassis No.1066
BD.26.	036 R 6155				4	4			Anti-rattle clip		From Chassis No.1066

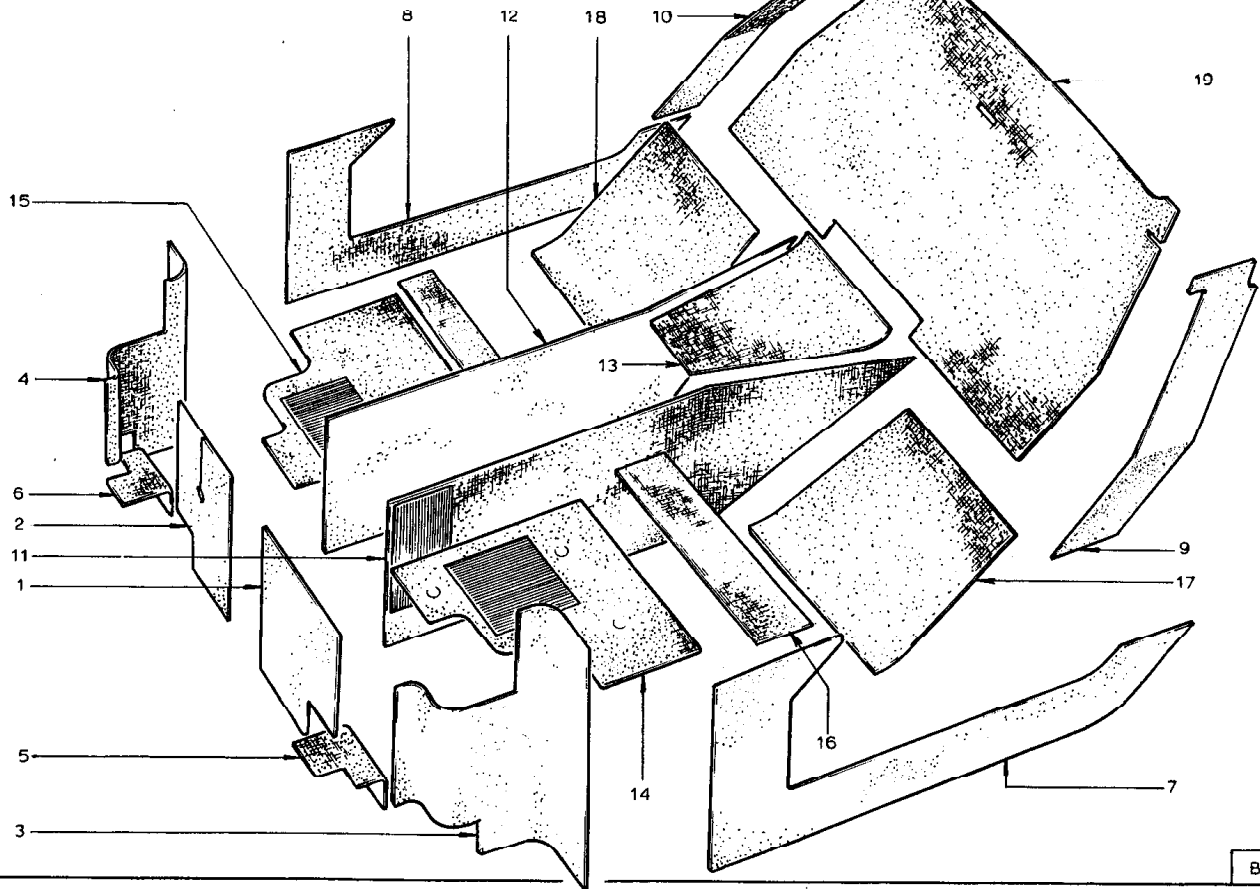

PLATE Ref. No.	PART No.	QUANTITY					STEERING		DESCRIPTION	CHANGE POINT	BULLETIN REFERENCE
		ALL	SI.	SI. Mk 1	S2.	S2. Fed.	RH	LH			
	046 B 0157		1	1							
BE.1.	A054 B 0157				1	1			Carpet - Toeboard/Footbox LH		
	046 B 0158		1	1					Carpet - Toeboard/Footbox LH		
BE.2.	A054 B 0158				1	1			Carpet - Toeboard/Footbox RH		
BE.3.	A046 B 0139	1							Carpet - Toeboard/Footbox RH		
BE.4.	A046 B 0140	1							Carpet - Wheelarch LH		
BE.5.	A054 B 1645				1	1	+		Carpet - Wheelarch RH		
	A054 B 1643				1	1		+	Carpet - Footbox Filler Piece LH, RHD		
BE.6.	A054 B 1646				1	1	+		Carpet - Footbox Filler Piece LH, LHD		
	A054 B 1644				1	1		+	Carpet - Footbox Filler Piece RH, RHD		
	046 B 6088	1	1						Carpet - Footbox Filler Piece, RH, LHD		
BE.7.	A054 B 0875				1	1			Carpet - Door Surround LH		
	046 B 6087	1	1						Carpet - Door Surround LH		
BE.8.	A054 B 0576				1	1			Carpet - Door Surround RH		
BE.9.	A054 B 1825				1	1			Carpet - Door Surround RH		
BE.10.	A054 B 1826				1	1			Carpet - Doorpost LH		
	046 B 0143		1	1					Carpet - Doorpost RH		
BE.11.	054 B 0143				1	1			Carpet - Tunnel Side LH		
	046 B 0144	1	1						Carpet - Tunnel Side LH		
BE.12.	054 B 0144				1	1			Carpet - Tunnel Side RH		
BE.13.	A054 B 1636				1	1			Carpet - Tunnel Side RH		
BE.14.	A05 B 2049	1					+		Carpet - Tunnel Top		
	A065 B 2053	1						+	Carpet - Floor LH		
BE.15.	A065 B 2050	1					+		Carpet - Floor LH		
	A065 B 2054	1						+	Carpet - Floor RH		
BE.16.	A065 B 2052	1						+	Carpet - Floor RH		
BE.17.	A054 B 1639				1	1			Carpet - Floor Underseat		
BE.18.	A054 B 1640				1	1			Carpet - Bulkhead Lower LH		
BE.19.	A054 B 1139				1	1			Carpet - Bulkhead Lower RH		
					1	1			Carpet - Bulkhead Upper		

BF

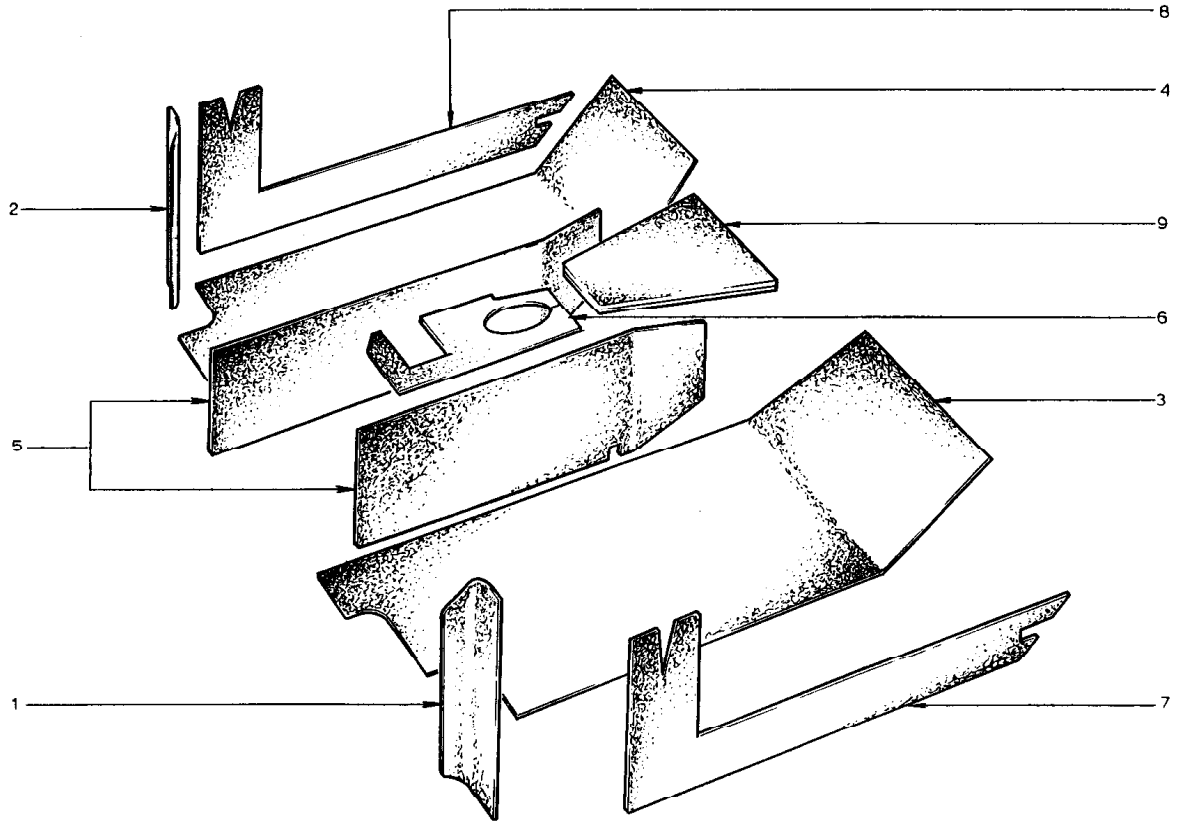

PLATE Ref: No.	PART No.	QUANTITY					STEERING		DESCRIPTION	CHANGE POINT	BULLETIN REFERENCE
		ALL	St.	St. Mk 1	S2.	S2. Fed.	RH	LH			
BF.1.	054 B 0165				1	1			Felt - Front Wheelarch LH		
BF.2.	054 B 0166				1	1			Felt - Front Wheelarch RH		
	046 B 0167		1	1					Felt - Floor LH		
BF.3.	054 B 0167				1	1			Felt - Floor LH		
	046 B 0168		1	1					Felt - Floor RH		
BF.4.	054 B 0168				1	1			Felt - Floor RH		
BF.5.	054 B 0175				1	1			Felt - Tunnel Side LH		
	054 B 0176				1	1			Felt - Tunnel Side RH		
	046 B 1139		1	1					Felt - Tunnel Saddle		
BF.6.	A054 B 0180				1	1			Felt - Tunnel Saddle		
BF.7.	054 B 1481				1	1			Felt - Door Surround LH		
BF.8.	054 B 1482				1	1			Felt - Door Surround RH		
BF.9.	A054 B 1483				1	1			Felt - Tunnel Top Rear		
	A054 B 0179				1	1			Felt - Tunnel Top Front		
	046 B 1137		1	1					Felt - Bulkhead		
	A054 B 1137				1	1			Felt - Bulkhead		
	046 B 1140		1	1					Felt - Front Box, Top		
	046 B 1154		1	1					Felt - Seat Back Adjusting		
	046 B 0625		1	1					Felt - Front Box Rear Face LH		
	046 B 0626		1	1					Felt - Front Box Rear Face RH		

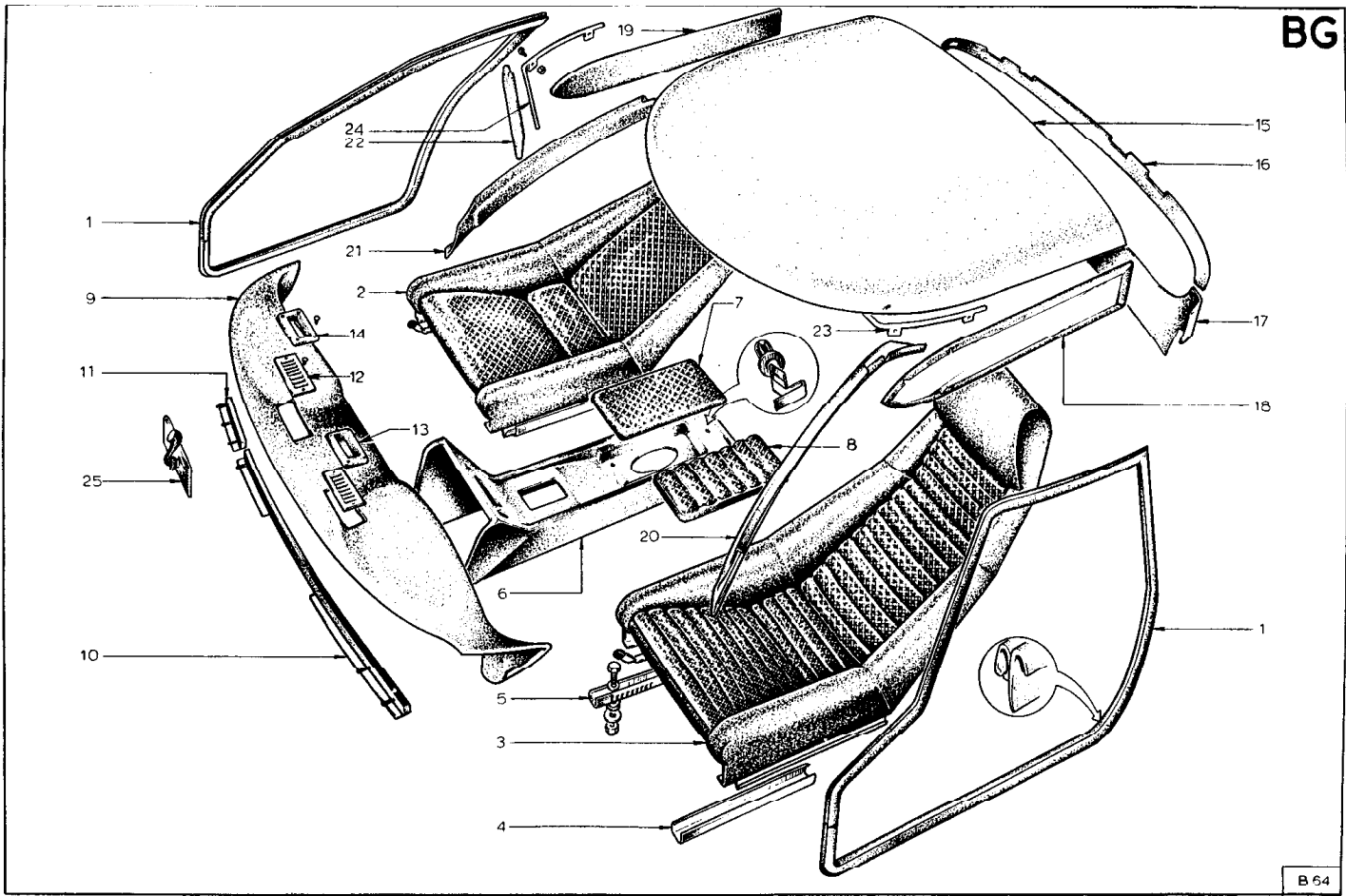



PLATE Ref: No.	PART No.	QUANTITY					STEERING		DESCRIPTION	CHANGE POINT	BULLETIN REFERENCE
		ALL	ST.	ST. Mk I	S2:	S2. Fed.	RH	LH			
	046 B 6022	1							Replaced by 054 B 1683		
BG.1.	054 B 1683	2							Door Seal		
BG.2.	046 B 0135		2	2					Seat Cushion and Squab		
	054 B 1174				2	2			Seat Assembly (Cirrus)	Upto:	
BG.3.	A065 B 1174				2	2			Seat Assembly (Ambla)	From:	
BG.4.	054 B 6016				2	2			Seat Runner		
BG.5.	054 B 6019				2	2			Seat Runner - with catch		
	XUFB 0510				8	8			Bolt )		
	A05W 1007				16	16			Washer )		
	YUFM 050F				12	12			Nut )	Seat Fixings	
	A05W 1606				16	16			Washer )		
	XUFB 0516				8	8			Bolt )		
	A05W 2006				8	8			Washer )		
	046 B 0243	1	1						Tunnel Cover and Armrest		
BG.6.	054 B 0243				1				Tunnel Cover	Upto Chassis No. 1329	
	A054 B 0243				1	1			Tunnel Cover	From Chassis No. 1330	
BG.7.	054 B 0811				1	1			Armrest (Cirrus)	Upto:	
BG.8.	A065 B 0811				1	1			Armrest (Ambla)	From:	
	W0010				2	2			Clip )		
	036 B 6007				2	2			Snap Sec )	Armrest to Tunnel	
BG.9.	050 B 0230				1	1			Crash Pad		
BG.10.	054 B 1161				1	1		+	Facia Rail - Main		
	054 B 1162				1			+	Facia Rail - Main		
BG.11.	054 B 1163				1	1			Facia Rail - End		
	054 B 1164				1			+	Facia Rail - End		
BG.12.	050 B 6049				2				Demist Grille		
	050 B 6049					2			Demist Grille	Upto Chassis No. 1463	
11.70											

PLATE Ref. No.	PART No.	QUANTITY					STEERING		DESCRIPTION	CHANGE POINT	BULLETIN REFERENCE
		ALL	S1.	S1. Mk 1	S2.	S2. Fed.	RH	LH			
	KSTS 0616				4				Screw )		
	KSTS 0616					4			Screw )		
	036 B 6001				4				Nut ) Demist Grille Mounting	Upto Chassis No. 1463	
	036 B 6001					4			Nut )	Upto Chassis No. 1463	
BG.13.	054 P 0069					1			Demist Nozzle Bezel LH	From Chassis No. 1464	
BG.14.	054 P 0070					1			Demist Nozzle Bezel RH	From Chassis No. 1464	
	KSTS 0416					8			Screw - Bezel to Mounting Bracket	From Chassis No. 1464	
	W0205		-	-					Headliner replaced by		
BG.15.	054 B 0360	1							Headliner		
BG.16.	054 B 1443				1	1			Rear Window Surround - Upper		
BG.17.	054 B 1484				1	1			Rear Window Surround - Lower		
BG.18.	054 B 0717				1	1			Centrail LH		
BG.19.	054 B 0718				1	1			Centrail RH		
	046 B 0361		1	1					Windscreen Pillar Trim LH		
BG.20.	054 B 0361				1	1			Windscreen Pillar Trim LH		
	046 B 0362		1	1					Windscreen Pillar Trim RH		
BG.21.	054 B 0362				1	1			Windscreen Pillar Trim RH		
	054 B 6049				-	-			Replaced by 054 B 1720		
BG.22.	054 B 1720				2	2			Sun Visor		
	046 B 1219		1	1					Mounting Bracket - Sun Visor		
BG.23.	046 B 1291				1	1			Mounting Bracket - Sun Visor LH		
	046 B 1220		1	1					Mounting Bracket - Sun Visor RH		
BG.24.	046 B 1292				1	1			Mounting Bracket - Sun Visor RH		
	PUPF 1008	2							Screw )		
	YUPN 100F	2							Nut ) Sun Visor Mounting Bracket to Body		
	A03W 0806		4	4					Washer )		
	A046 B 6039	-							Replaced by 036 B 6031		
BG.25.	036 B 6031	1							Interior Mirror		

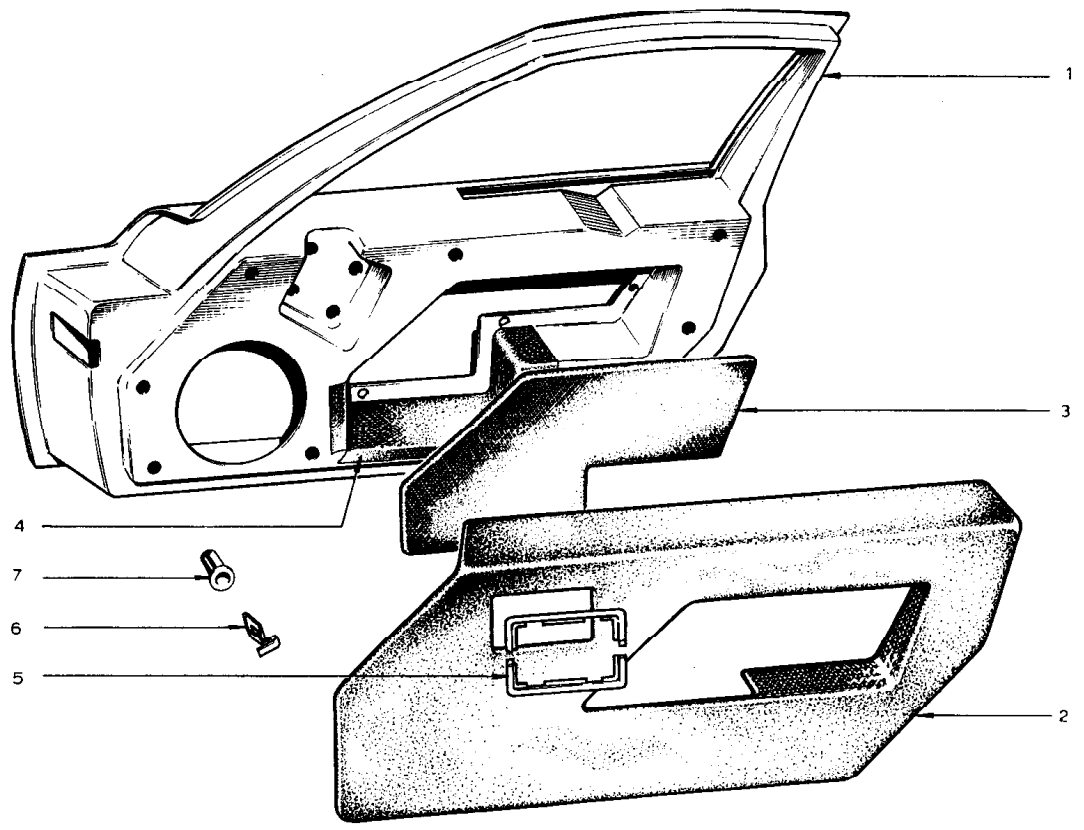

PLATE Ref. No.	PART No.	QUANTITY					STEERING		DESCRIPTION	CHANGE POINT	BULLETIN REFERENCE
		ALL	ST.	ST. Mk 1	S2.	S2. Fed.	RH	LH			
	046 B 0088		1	1					Door Shell LH	Up to Chassis No. 0644	
	054 B 0089				1				Door Shell LH	From Chassis No. 0645 to 1065	
	A054 B 0089					1			Door Shell LH	From Chassis No. 1066	
BH.1.	046 B 0089		1	1					Door Shell RH	Up to Chassis No. 0644	
	054 B 0088				1				Door Shell RH	From Chassis No. 0645 to 1065	
	A054 B 0088					1			Door Shell RH	From Chassis No. 1066	
	046 B 0427		2	2					Door Trim Panel	Up to Chassis No. 0644	
	054 B 0721				1	1			Door Trim Panel LH	From Chassis No. 0645	
BH.2.	054 B 0722				1	1			Door Trim Panel RH	From Chassis No. 0645	
BH.3.	054 B 0918				1	1			Aperature Panel - Armrest Recess, RH	From Chassis No. 0645	
	054 B 0919				1	1			Aperature Panel - Armrest Recess, LH	From Chassis No. 0645	
BH.4.	054 B 1698				2	2			*Perforated* Trim Material	From Chassis No. 0645	
BH.5.	054 B 6059				2	2			Bezel - Remote Control		
BH.6.	W0010				16	16			Clip - Trim Panel Mounting		
BH.7.	046 B 6037				16	16			Snap Sac, Trim Panel Mounting		
	046 B 6020		2	2					Pocket Trim Strip		

BJ

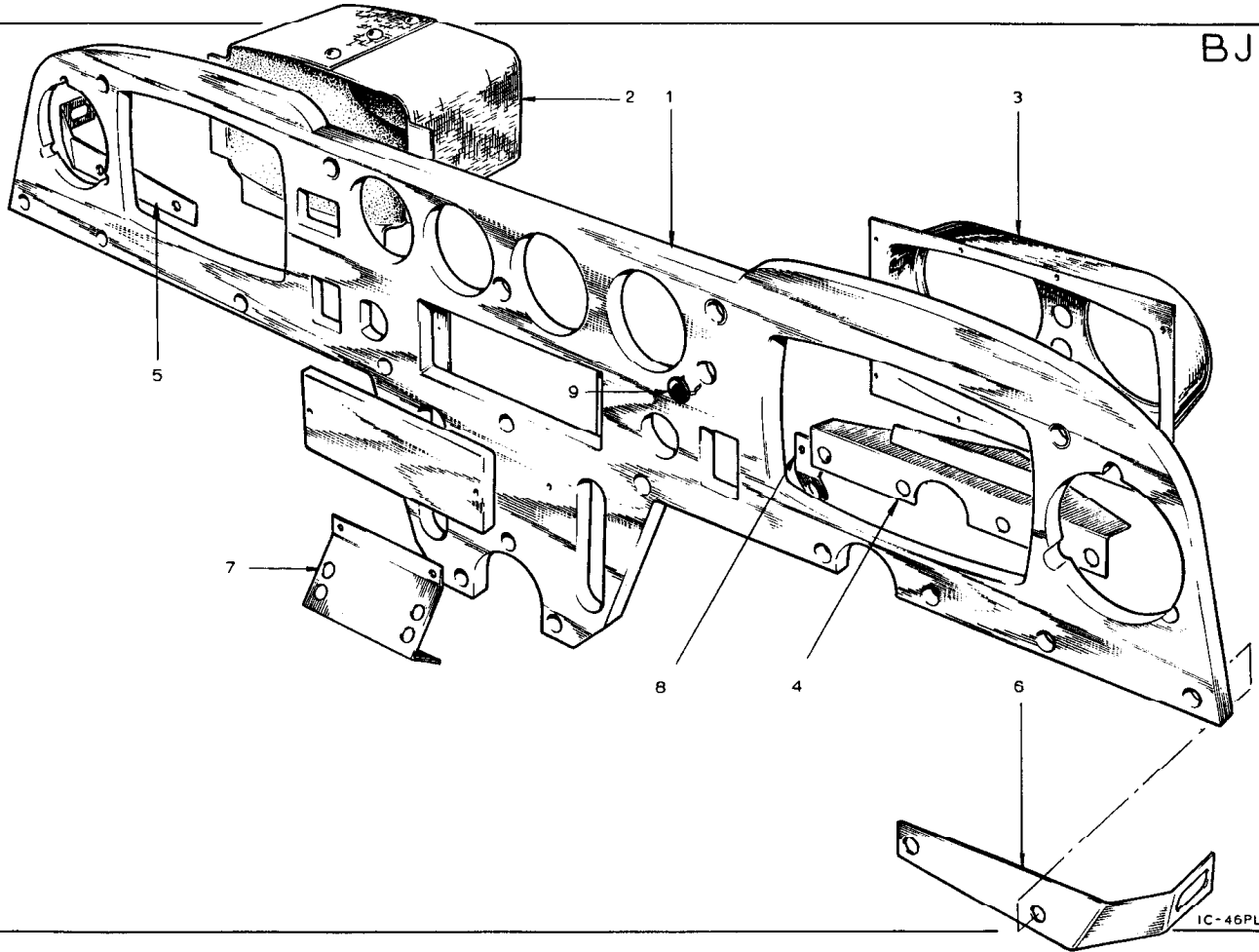
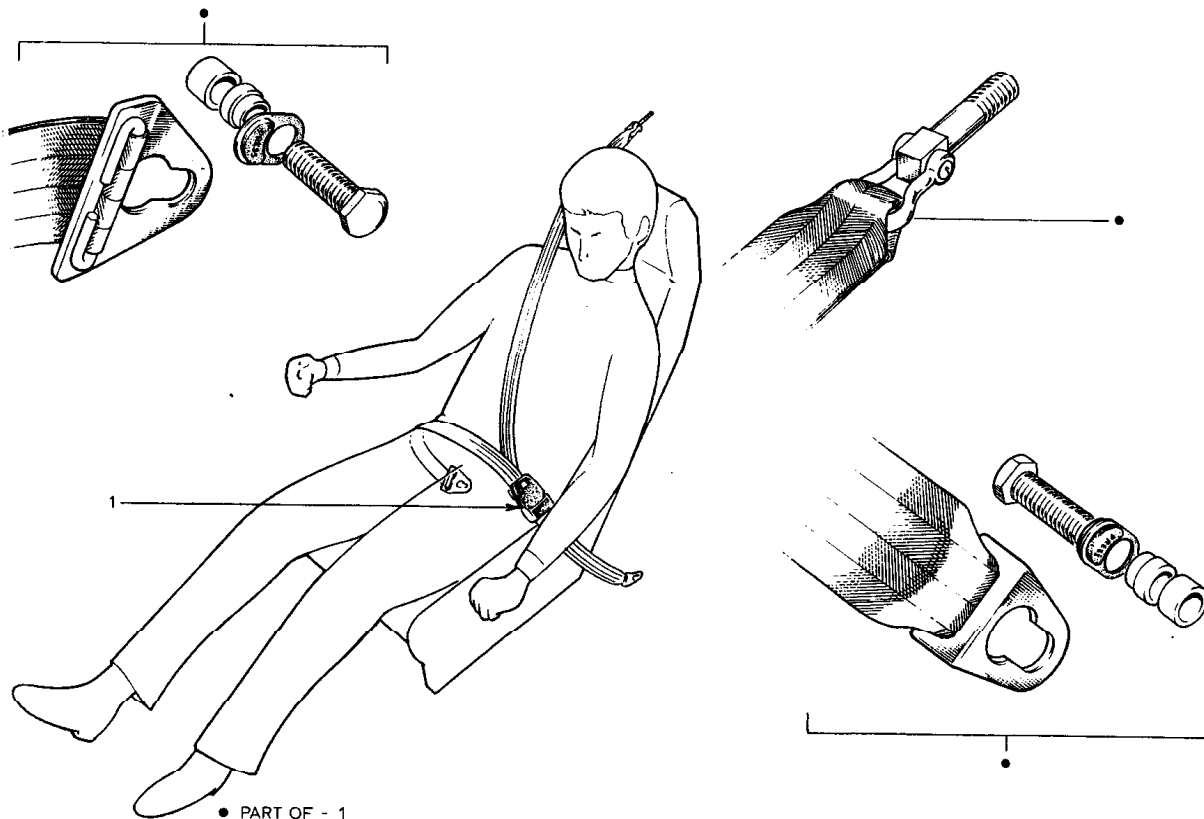

PLATE Ref. No.	PART No.	QUANTITY					STEERING		DESCRIPTION	CHANGE POINT	BULLETIN REFERENCE
		ALL	S1.	S1. Mk I	S2.	S2. Fed.	RH	LH			
	046 B 0237		1					+	Facia Panel	Upto Chassis No. 0299 excluding 0270, 0271 and 0272	
	A046 B 0237			1				+	Facia Panel	From Chassis No. 0300 including 0270, 0271 and 0272	
BJ.1.	046 B 1071		1	1					Instrument Mounting Panel		
	054 B 0238				1			+	Facia Panel	Upto Chassis No. 1172	
	054 B 0237				1			+	Facia Panel	Upto Chassis No. 1306	
	054 B 0238A				1			+	Facia Panel	From Chassis No. 1173	
	054 B 0237A				1			+	Facia Panel - except Sweden 1970	From Chassis No. 1387	
	A054 B 0237					1		+	Facia Panel	From Chassis No. 1066	
	A054 B 0237				1			+	Facia Panel without hazard warning and brake fail marking - Sweden only	From January 1970	
BJ.2.	054 B 0195				1	1			Glove Box		
BJ.3.	054 B 1408				1	1			Instrument Binnacle		
	RWDS 0406				17	17			Screw - Instrument Binnacle and Glove Box to Facia		
BJ.4.	054 II 0031				1	1			Support Bracket - Steering Column		
	A034 0806				2	2			Washer )		
	RWDS 0406				2	2			Screw ) Support Bracket to Facia		
BJ.5.	054 B 1459				1	1			Facia Support Bracket	Upto Chassis No.	
	A054 B 1459				1	1			Facia Support Bracket	From Chassis No.	
BJ.6.	054 B 1460				1	1			Facia Support Bracket	Upto Chassis No.	
	A054 B 1460				1	1			Facia Support Bracket	From Chassis No.	
	AUFN 030F				4	4			Nut )		
	A034 0806				4	4			Washer ) Support Bracket/Facia Rail to Facia Panel		
BJ.7.	054 B 1462				1	1			Mounting Bracket - Window Switches and Ashtray		
	433B				4	4			Rivet - Mounting Bracket to Tunnel Top		
03.70											

PLATE Ref. No.	PART No.	QUANTITY					STEERING		DESCRIPTION	CHANGE POINT	BULLETIN REFERENCE
		ALL	SI.	SI. Mk I	S2.	S2. Fed.	RH	LH			
BJ.8.	054 B 1463				1				Mounting Bracket - Speedometer Trip Cable		
	054 B 1539					1			Mounting Bracket - Speedometer Trip Cable		
BJ.9.	036 B 6114				2				Blanking Grommet		
	443 B				1				Blanking Grommet (Germany, Italy, Switzerland and Japan)	Tot	
	050 B 6155					1			Blanking Grommet		
	KSTS 0612	10	10						Screw )		
	54 B 6003				4	4			Screw )		
	W 0092	10	10						'Cup Washer' )		
	XUFS 0412				2	2			Screw )	Facia Mounting	
	YUPN 040P				2	2			nut )		
	A04W 0904				2	2			Washer )		
	PO4W 0805				2	2			Washer, Fibre )		
	054 B 1345				2	2			Mounting Angle )		
	A046 B 0197				1				Glove Box Lid		
	046 B 6121				1				Hinge- Glove Box		
	046 B 6122				1				Check Strap		
	036 B 6033				6				Rivet - Hinge to Facia		
	KSPS 0306				6				Screw - Hinge to Lid		
	KUPS 0646				10				Screw - Facia Mounting		



● PART OF - 1



PLATE Ref: No.	PART No.	QUANTITY					STEERING		DESCRIPTION	CHANGE POINT	BULLETIN REFERENCE
		ALL	SI.	SI. Mk 1	S2.	S2. Fed.	RH	LH			
	046 B 0780	2							Seat Belt Kit	Upto	
BK.1.	A046 B 0780	2							Seat Belt Kit	From	

BL

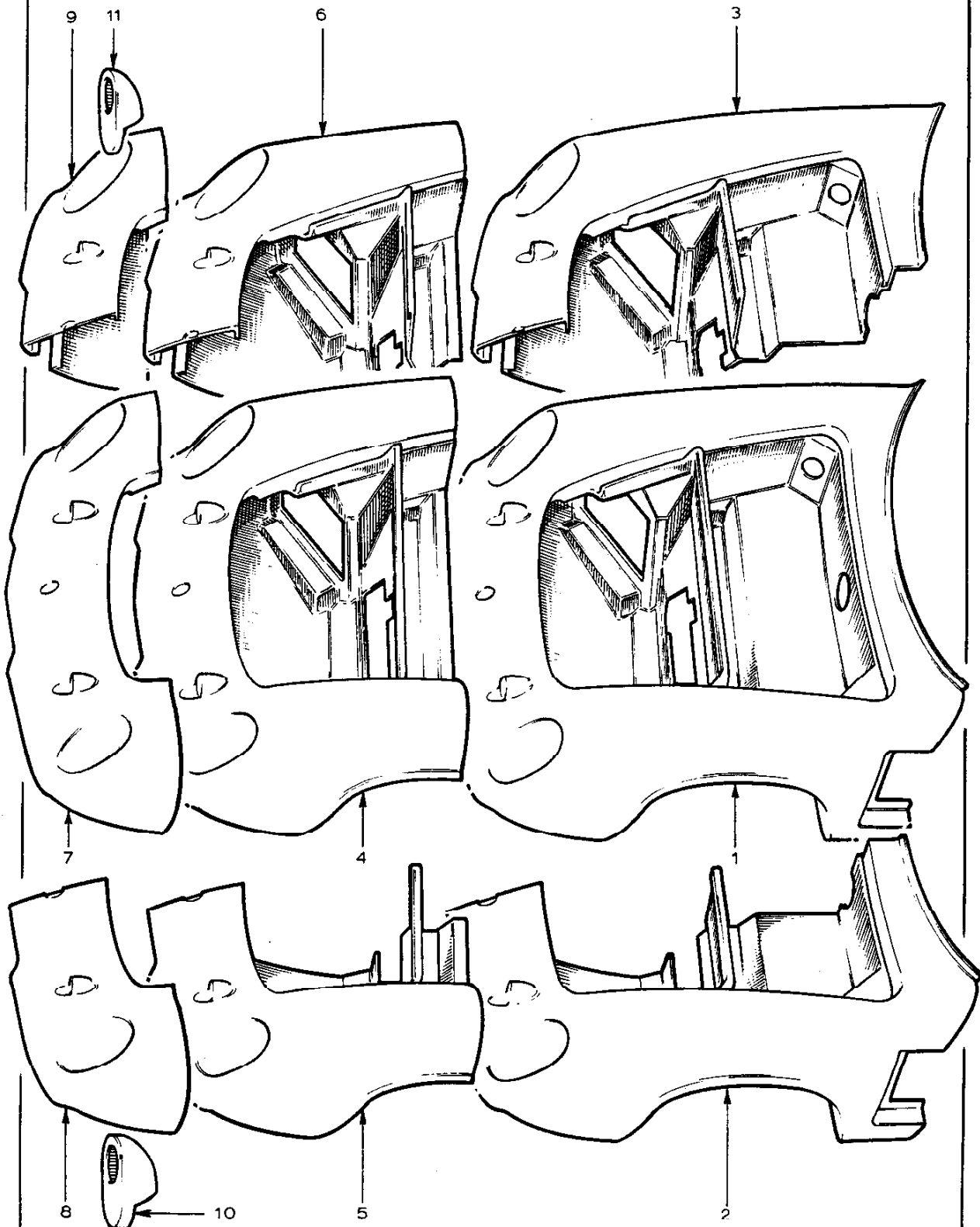

PLATE Ref. No.	PART No.	QUANTITY					STEERING		DESCRIPTION	CHANGE POINT	BULLETIN REFERENCE
		ALL	ST.	ST. Mk 1	S2.	S2. Fed.	RH	LH			
BL.1.	046 B 6130		1	1					Full Front Section	Upto Chassis No. 0644	
	054 B 6040				1				Full Front Section	From Chassis No. 0645	
	A054 B 6040					1			Full Front Section	Upto Chassis No.	
BL.2.	065 B 6000					1			Full Front Section	From Chassis No.	
	046 B 6131		1	1					Half Full Front Section LH	Upto Chassis No. 0644	
	054 B 6041				1				Half Full Front Section LH	From Chassis No. 0645	
BL.3.	A054 B 6041					1			Half Full Front Section LH	Upto Chassis No.	
	065 B 6001					1			Half Full Front Section LH	From Chassis No.	
	046 B 6132		1	1					Half Full Front Section RH	Upto Chassis No. 0644	
BL.4.	054 B 6042				1				Half Full Front Section RH	From Chassis No. 0645	
	A054 B 6042					1			Half Full Front Section RH	Upto Chassis No.	
	065 B 6002					1			Half Full Front Section RH	From Chassis No.	
BL.5.	046 B 6127		1	1					Mid Full Front Section	Upto Chassis No. 0644	
	054 B 6053				1				Mid Full Front Section	From Chassis No. 0645	
	A054 B 6053					1			Mid Full Front Section	Upto Chassis No.	
BL.6.	065 B 6003					1			Mid Full Front Section	From Chassis No.	
	046 B 6129		1	1					Half Mid Front Section LH	Upto Chassis No. 0644	
	054 B 6054				1				Half Mid Front Section LH	From Chassis No. 0645	
BL.7.	A054 B 6054					1			Half Mid Front Section LH	Upto Chassis No.	
	065 B 6005					1			Half Mid Front Section LH	From Chassis No.	
	046 B 6128		1	1					Half Mid Front Section RH	Upto Chassis No. 0644	
BL.8.	054 B 6055				1				Half Mid Front Section RH	From Chassis No. 0645	
	A054 B 6055					1			Half Mid Front Section RH	Upto Chassis No.	
	065 B 6006					1			Half Mid Front Section RH	From Chassis No.	
03.70											

PLATE Ref: No.	PART No.	QUANTITY					STEERING		DESCRIPTION	CHANGE POINT	BULLETIN REFERENCE
		ALL	ST.	ST. Mk 1	S2.	S2. Fed.	RH	LH			
BL.7.	046 B 6104		1	1					Short Nose Section	Up to Chassis No. 0644	
	054 B 6056				1				Short Nose Section	From Chassis No. 0645	
	A054 B 6056					1			Short Nose Section	Up to Chassis No.	
BL.8.	046 B 6097		1	1					Short Nose Section	From Chassis No.	
	054 B 6057				1				Half Short Nose LH	Up to Chassis No. 0644	
	A 054 B 6057					1			Half Short Nose LH	From Chassis No. 0645	
BL.9.	065 B 6007					1			Half ShortFront LH	Up to Chassis No.	
	046 B 6096		1	1					Half ShortFront LH	From Chassis No.	
	054 B 6068				1				Half Short Front RH	U; to Chassis No. 0644	
BL.10.	A054 B 6068					1			Half Short Front RH	From Chassis No. 0645	
	065 B 6008					1			Half Short Front RH	Up to Chassis No.	
	054 B 0933					1			Headlamp Pod LH	From Chassis No. 1450 to 2061	
B.L.11.	A054 B 0933					1			Headlamp Pod LH	From Chassis No. 2067 to	
	054 B 0934					1			Headlamp Pod RH	From Chassis No. 1450 to	

BM

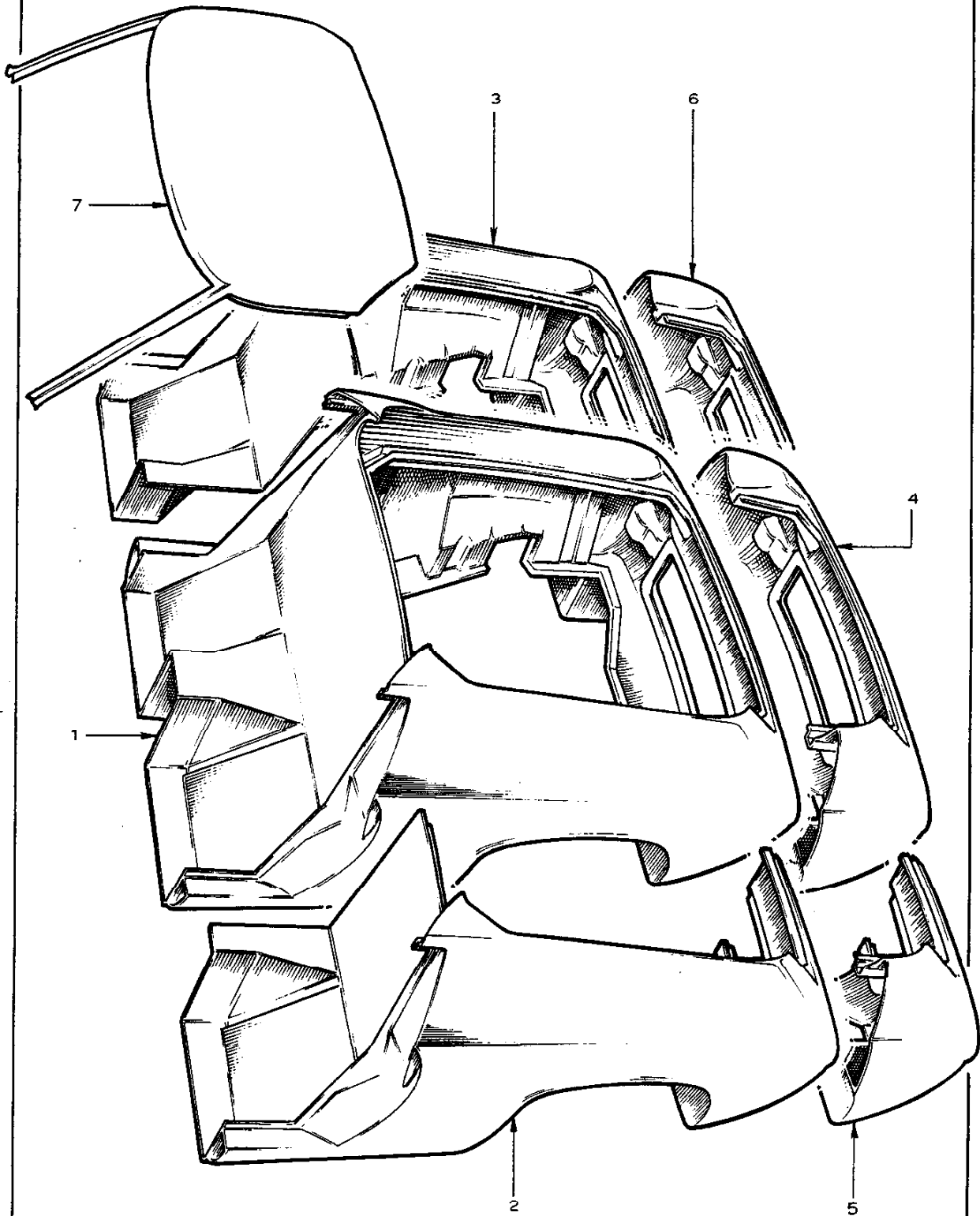

PLATE Ref: No.	PART No.	QUANTITY					STEERING		DESCRIPTION	CHANGE POINT	BULLETIN REFERENCE
		ALL	SI.	SI. Mk 1	S2.	S2. Fed.	RH	LH			
BM.1.	046 B 6101	1	1						Full Rear Section	Up to Chassis No. 0542	
	054 B 6043				1	1			Full Rear Section	From Chassis No. 0543	
BM.2.	046 B 6103	1	1						Half Full Rear LH	Up to Chassis No. 0542	
	054 B 6045				1	1			Half Full Rear LH	From Chassis No. 0542	
BM.3.	046 B 6102	1	1						Half Full Rear RH	Up to Chassis No. 0542	
	054 B 6044				1	1			Half Full Rear RH	From Chassis No. 0543	
BM.4.	046 B 6100	1	1						Short Rear	Up to Chassis No. 0542	
	054 B 6046				1	1			Short Rear	From Chassis No. 0543	
BM.5.	046 B 6099	1	1						Half Short Rear LH	Up to Chassis No. 0542	
	054 B 6047				1	1			Half Short Rear LH	From Chassis No. 0543	
BM.6.	046 B 6098	1	1						Half Short Rear RH	Up to Chassis No. 0542	
	054 B 6048				1	1			Half Short Rear RH	From Chassis No. 0543	
BM.7.	A046 B 6138	1							Roof Panel including Windscreen Pillars	Up to Chassis No.	