

DA

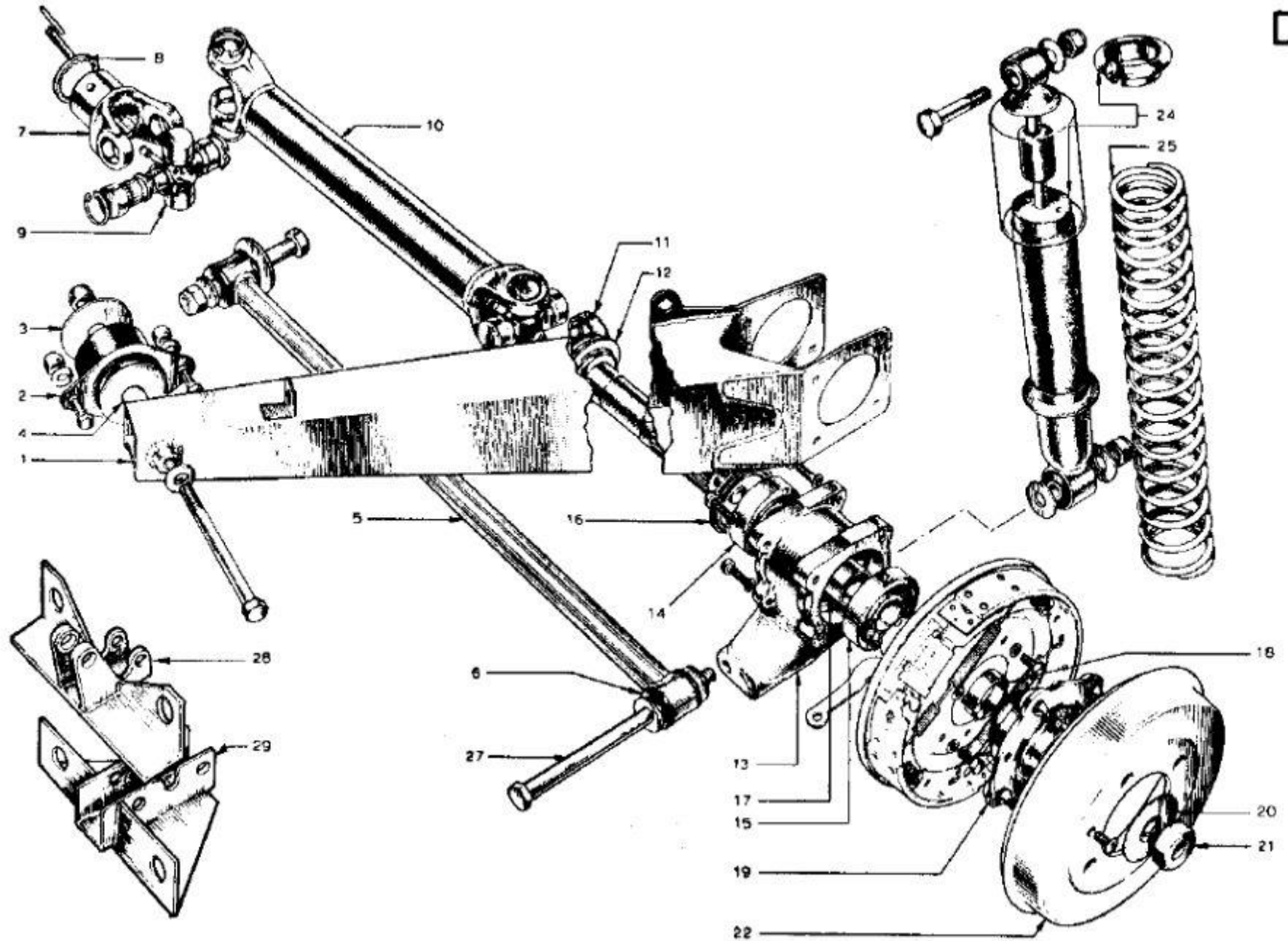

Lotus Europa TC/TCS Parts Manual - Section DA - Suspension - Rear - Page 2

Item	Lotus #	S1	S1A/B	S2	S2 Fed	TC	TC Fed	TCS	TCS F	LHD	RHD	Description	Change Point Notes Bulletin Reference
1	A074D0197Z					1	1			+	+	Arm - Radius L/H	
1	A074D0217Z							1	1	+	+	Arm - Radius L/H	
1	A074D0198Z					1	1			+	+	Arm - Radius R/H	
1	A074D0216Z							1	1	+	+	Arm - Radius R/H	
2	X046D6000Z					2	2	2	2			Resilient Mounting (Metalastic)	
2	36A					2	2	2	2			Bolt - Mounting to Arm	
2	128					2	2	2	2			Washer - Mounting to Arm	
3	A07W3212					2	2	2	2			Washer - Mounting to Arm	
3	216					2	2	2	2			Nut - Mounting to Arm	
3	13					4	4	4	4			Bolt - Mounting to Chassis	
3	119					4	4	4	4			Washer - Mounting to Chassis	
3	211					4	4	4	4			Nut - Mounting to Chassis	
4	A074D0205Z											Shim - Radius Arm 1/8 ins. (As Required)	
4	A074D0206Z											Shim - Radius Arm 1/16 ins. (As Required)	
5	B074D0195Z					2	2	2	2			Link - Lower	
6	A074D6002Z					4	4	4	4			Bush - Lower Link	
6	37					2	2	2	2			Bolt - Lower Link to Gearbox	
6	128F					4	4	4	4			Washer - Lower Link to Gearbox	
6	219					2	2	2	2			Nut - Lower Link to Gearbox	
6	A074D0756W					2	2			+	+	Assembly - Drive Shaft (Use with Type 336 Gearbox)	
6	A074D0749W					2	2	2	2			Assembly - Drive Shaft (Use with Type 352/365 Gearboxes)	
7	A074D6006Z					2	2			+	+	Yoke (For A074D0756W)	
7	A074D6010Z					2	2	2	2			Yoke (For A074D0749W)	
9	A074D6008Z					4	4	4	4			Universal Joint (For A074D0756W and A074D0749W)	
10	A074D6004Z					2	2	2	2			Shaft - Inboard Drive (For A074D0756W and A074D0749W)	
11	A074D6005Z					2	2	2	2			Shaft - Outboard Drive (For A074D0756W and A074D0749W) (Rear Stub Axle)	
12	A074D0196Z					2	2	2	2			Flinger (For A074D0756W and A074D0749W)	
8	X046R0022Z											Spacer Ring (0.405 ins. Undersize) (As Required)	
8	X046R0023Z											Spacer Ring (0.410 ins. Undersize) (As Required)	
8	X046R0024Z											Spacer Ring (1st Oversize) (As Required)	
8	X046R0025Z											Spacer Ring (2nd Oversize 0.420 ins) (As Required)	

DA

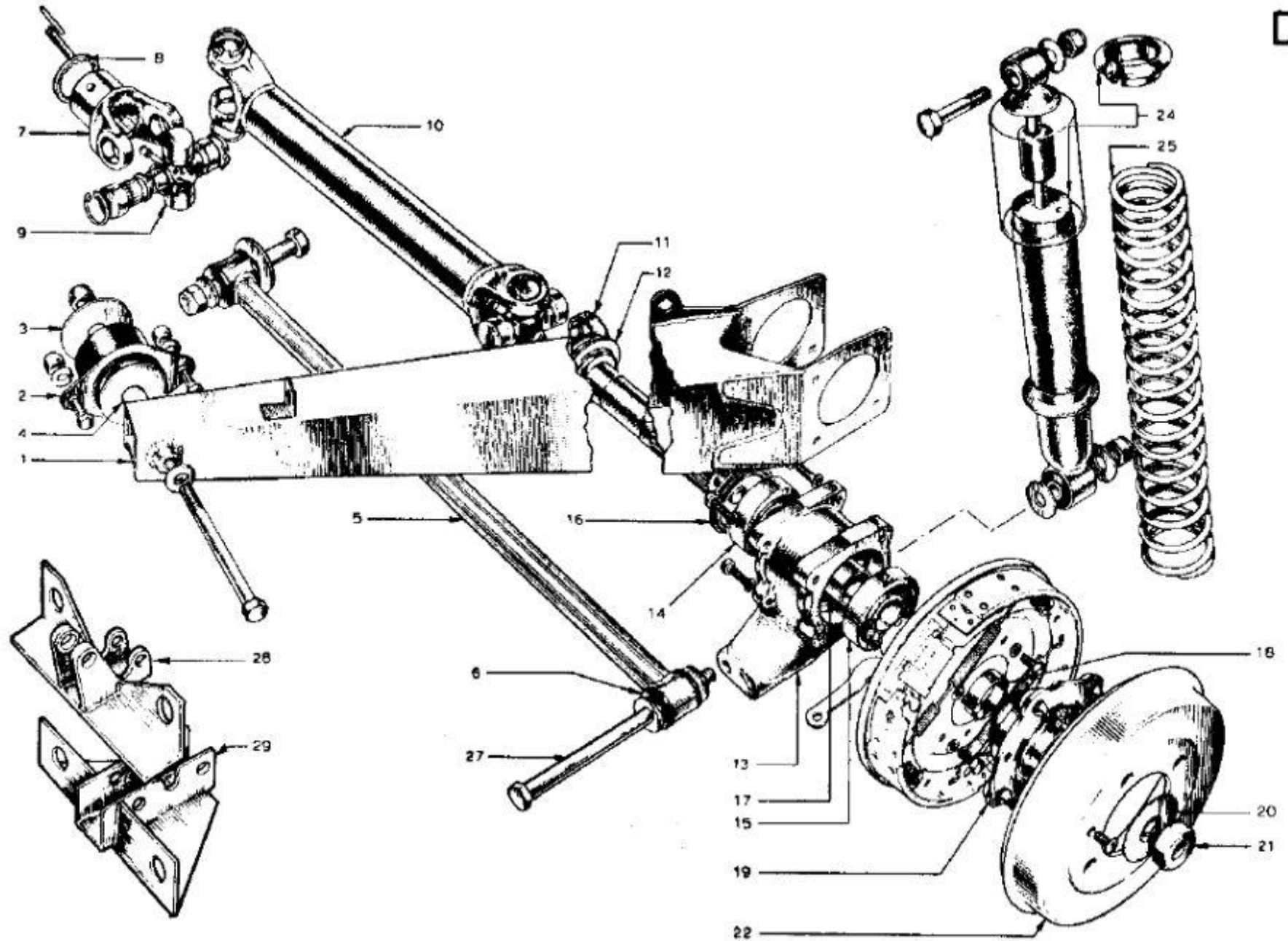

Lotus Europa TC/TCS Parts Manual - Section DA - Suspension - Rear - Page 4

Item	Lotus #	S1	S1A/B	S2	S2 Fed	TC	TC Fed	TCS	TCS F	LHD	RHD	Description	Change Point Notes Bulletin Reference
8	X046R0026Z											Spacer Ring (3rd Oversize) (As Required)	
8	A054D0187Z											Shim (0.005 ins) (As Required)	
8	A054D0188Z											Shim (0.015 ins) (As Required)	
8	X046R6000Z					2	2					Tension Pin - Outer - Dive Shaft to Gearbox	
8	X046R6001Z					2	2					Tension Pin - Inner - Drive Shaft to Final Drive	
8	A074F6013Z					2	2	2	2			Pin - Drive Shaft to Gearbox	Use on A074D0749W)
13	B074D0193Z					1	1			+	+	Housing - Wheel Bearing L/H	
13	E074D0193Z							1	1	+	+	Housing - Wheel Bearing - R/H	
13	B074D0194Z					1	1			+	+	Housing - Wheel Bearing - R/H	
13	E074D0194Z							1	1	+	+	Housing - Wheel Bearing - R/H	
13	10					8	8	8	8			Setscrew - Attaching - Housing - Wheel Bearing	
13	116					8	8	8	8			Washer - Attaching - Housing - Wheel Bearing	
14	A074D6001Z					2	2			+	+	Wheel Bearing Rear Inner	
14	X036D6017Z							2	2	+	+	Wheel Bearing Rear Inner	
15	X036D6017Z					2	2	2	2			Wheel Bearing Rear Outer	
16	A074D6000Z					2	2			+	+	Seal - Wheel Bearing	
16	A074D6009Z							2	2	+	+	Seal - Wheel Bearing	
17	X046D0148Z					2	2			+	+	Spacer - Wheel Bearing to Wheel Bearing	
17	A074D0215Z							2	2	+	+	Spacer - Wheel Bearing to Wheel Bearing	
18	A074D0208Z					2	2	2	2			Spacer - Hub	
19	A046D0007Y					2	2			+	+	Hub	
19	A074D0214Y							2	2	+	+	Hub	
20	X046D6006Z					2	2	2	2			Washer - Hub Retaining	
21	X046D6007Z					2	2	2	2			Hub Retaining Nut	
22	X046J6023Z					2	2			+	+	Brake Drum	
22	A074J6036Z							2	2	+	+	Brake Drum	
22	KUFS0408					1	1	1	1			Brake Drum to Hub Attaching Screw	
22	X036D6002Z					8	8	8	8			Wheel Stud	Thread: 3/8-24, Knurl Dia.: .519", Length: 1.237", Shoulder Length: .455"
22	D074D0757W					2	2	2	2			Assembly - Damper/Spring	
24	A074D6007W					2	2	2	2			Damper Assembly - Assembly - Damper/Spring	
25	B026C0010A					2	2	2	2			Spring - Assembly - Damper/Spring	
27	A074D0209Z					2	2	2	2			Bolt - Damper/Lower Link to Housing	

Lotus Europa TC/TCS Parts Manual - Section DA - Suspension - Rear - Page 6

Item	Lotus #	S1	S1A/B	S2	S2 Fed	TC	TC Fed	TCS	TCS F	LHD	RHD	Description	Change Point Notes Bulletin Reference
27	129					4	4	4	4			Washer - Damper/Lower Link to Housing	
27	12BF					4	4	4	4			Washer - Damper/Lower Link to Housing	
27	219					2	2	2	2			Nut - Damper/Lower Link to Housing	
27	37					2	2	2	2			Bolt - Damper to Cross Beam	
27	129					2	2	2	2			Washer - Damper to Cross Beam	
27	219					2	2	2	2			Nut - Damper to Cross Beam	
28	C074A0721W					1	1	1	1			Mounting - Lower Link to Type 352/365 Gearbox	
29	B074A0716W					1	1			+	+	Mounting - Lower Link to Type 336 Gearbox	